

# BEAMZ

## MADE EAZY



## FUZE SERIES

### MOVING HEADS

SHARE YOUR SKILLS



#BEAMZ #LIGHTING

## FUZE75S SPOT LED MOVING HEAD



### AE0382

- o 75W High Intensity White LED
- o 11 or 13 DMX channels
- o DMX and Stand-alone mode
- o Master/slave synchronization
- o Beam angle 11°
- o Gobo Wheel: 6x metal gobos + open (interchangeable)
- o Gobo functions: gobo shake and gobo rotation
- o 8 Colours + open
- o Rotatable 3 facet prism
- o Motorized focus
- o 0-100% electronic dimmer
- o User-selectable pan and tilt
- o Strobe: 1-11Hz
- o Automatic pan/tilt correction
- o Reset function
- o Control panel with LCD display
- o DMX in/output via 3-pin XLR
- o Powerconnector input
- o With quick lock omega clamp
- o DMX cable included
- o Powerconnector cable and safety cord included
- o Remote control included

**75W  
WHITE  
LED**

**METAL  
GOBOS**



## FUZE75S KIT 2 MOVING HEADS IN FLIGHTCASE

### AE0383

- o Sturdy moving head flightcase with handles
- o Designed to fit 2 pieces Fuze series moving heads
- o Butterfly locks and aluminium profiles all around
- o Provided with tailor-made solid foam on the inside



## FUZE75B BEAM LED MOVING HEAD

**75W  
WHITE  
LED**

**METAL  
GOBOS**

### AE0384

- o 75W High Intensity White LED
- o 10 or 12 DMX channels
- o DMX and Stand-alone mode
- o Master/slave synchronization
- o Beam angle 2°
- o Fresnel lens
- o Gobo Wheel: 17x metal gobos + open
- o Gobo shake function
- o 12 Colours + open
- o Rotatable 8 facet prism
- o 0-100% electronic dimmer
- o Pan and Tilt Ranges: 360°, 540°, 630° pan / 90°, 180°, 270° tilt movement
- o Strobe: 1-11Hz
- o Automatic pan/tilt correction
- o Reset function
- o Control panel with LCD display
- o DMX in/output via 3-pin XLR
- o Powerconnector input
- o With quick lock omega clamp
- o DMX cable included
- o Powerconnector cable and safety cord included
- o Remote control included



## FUZE75B KIT 2 MOVING HEADS IN FLIGHTCASE

### AE0385

- o Sturdy moving head flightcase with handles
- o Designed to fit 2 pieces Fuze series moving heads
- o Butterfly locks and aluminium profiles all around
- o Provided with tailor-made solid foam on the inside



# FUZE610Z WASH LED MOVING HEAD

**RGBW  
LEDS**

**ZOOM  
FUNCTION**

## AE0386

- o 6x 10 RGBW LEDs
- o 13 or 15 DMX channels
- o DMX and Stand-alone mode
- o Master/slave synchronization
- o Beam angle 2°
- o Electronic linear zoom
- o 0-100% electronic dimmer
- o Strobe: 1-21Hz
- o Automatic pan/tilt correction
- o Reset function
- o Control panel with LCD display
- o DMX in/output via 3-pin XLR
- o Powerconnector input
- o With quick lock omega clamp
- o DMX cable included
- o Powerconnector cable and safety cord included
- o Remote control included

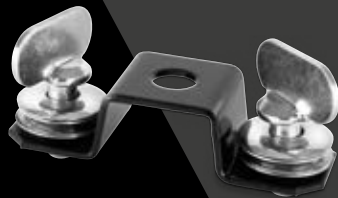

## FUZE610Z KIT 2 MOVING HEADS IN FLIGHTCASE



## AE0387

- o Sturdy moving head flightcase with handles
- o Designed to fit 2 pieces Fuze series moving heads
- o Butterfly locks and aluminium profiles all around
- o Provided with tailor-made solid foam on the inside

## FCFZ4 FLIGHTCASE



AE0392  
o For 4 Fuze Series moving heads

## FCFZ2 FLIGHTCASE



AE0390  
o For 2 Fuze Series moving heads

**ego** technologies  
for entertainment

**beamZ**